

NPT Compression Fittings—Technical Guide

Note: for Reference purposes only

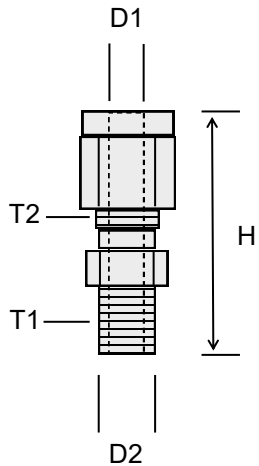

	T1	T2	H	D1 (ID)	D2 (OD)	For Thermocouple Probe Sheath O.D.
CF-0062-18-NPT*	1/8"-NPT	10-32	1.0" (25 mm)	0.064" (1.6 mm)	0.40" (10 mm)	1/16"
CF-0062-14-NPT**	1/4"-NPT	10-32	1.3" (33 mm)	0.064" (1.6 mm)	0.54" (14 mm)	1/16"
CF-0125-18-NPT	1/8"-NPT	5/16-20	1.2" (30 mm)	0.135" (3.4 mm)	0.40" (10 mm)	1/8"
CF-0125-14-NPT	1/4"-NPT	5/16-20	1.4" (36 mm)	0.135" (3.4 mm)	0.54" (14 mm)	1/8"
CF-0187-18-NPT	1/8"-NPT	3/8-20	1.3" (33 mm)	0.192" (4.9 mm)	0.40" (10 mm)	3/16"
CF-0187-14-NPT	1/4"-NPT	3/8-20	1.4" (36 mm)	0.192" (4.9 mm)	0.54" (14 mm)	3/16"
CF-0250-18-NPT	1/8"-NPT	7/16-20	1.3" (33 mm)	0.258" (6.5 mm)	0.40" (10 mm)	1/4"
CF-0250-14-NPT	1/4"-NPT	7/16-20	1.5" (38 mm)	0.258" (6.5 mm)	0.54" (14 mm)	1/4"
CF-0250-12-NPT	1/2" NPT	7/16-20	1.75" (44.5 mm)	0.258" (6.5 mm)	.84" (21 mm)	1/4"

Material	316 Stainless Steel
Number of Ferrules	2 (double type) * CF-0062-18-NPT is single type ** CF-0062-14-NPT is single type
Pressure Rating (1/8"-NPT)	6500 PSI (447 bar)
Pressure Rating (1/4"-NPT)	6600 PSI (454 bar)
Pressure Rating (1/2"-NPT)	6600 PSI (454 bar)

Tightening the fitting

- For 1/16" to 3/16" outer diameter probes turn 3/4 past finger tight
- For 1/4" outer diameter probes turn 1-1/4 past finger tight
- For reassembly after initial installation turn 1/4 past finger tight

Order of Assembly

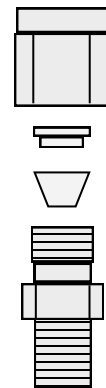

Thread	Drill	Tap
1/8"-NPT	The recommended drill bit size is "R" (.339") or "Q" (.332"). Or, the closest fractional is 11/32 (.342")	1/8 x 27 NPT
1/4"-NPT	7/16 (0.438")	1/4 x 18 NPT
1/2"-NPT	45/64 (0.703")	1/2 x 14 NPT