

MINIATURE SURFACE MOUNT BOLT DOWN OR CEMENT ON THERMOCOUPLE

Bolt Down or Cement On Surface Thermocouple

FEATURES

- Type E, J, K, or T thermocouple
- Fitting housing is aluminum for fast thermal response
- Made in the USA
- FEP Teflon™ insulated wires
- Designed for research & development applications

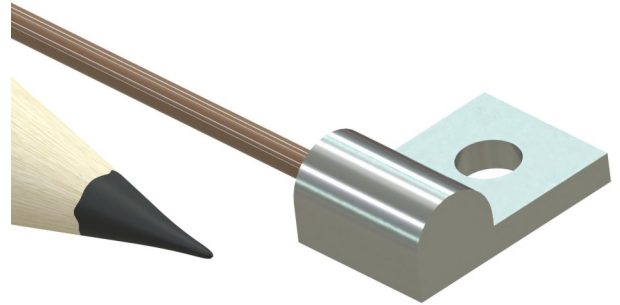

SPECIFICATIONS

Thermocouple type: E, J, K or T
Range: -50 to 500°F (-45 to 260°C)
Accuracy: Greater of +/-0.4% of reading or +/- 1.1°C (Special Limits of Error)

Fitting Housing Material: Aluminum
IP Rating: IEC IP64

Response Time*: 6 Seconds
***Time Constant:** Defined as the time required to reach 63.2% of an instantaneous temperature change
 Five time constants are required to approach 100% of the step change value

Lead Wire: FEP Teflon™ insulated, 30 AWG, solid conductors, insulation rated to 400°F (204°C)

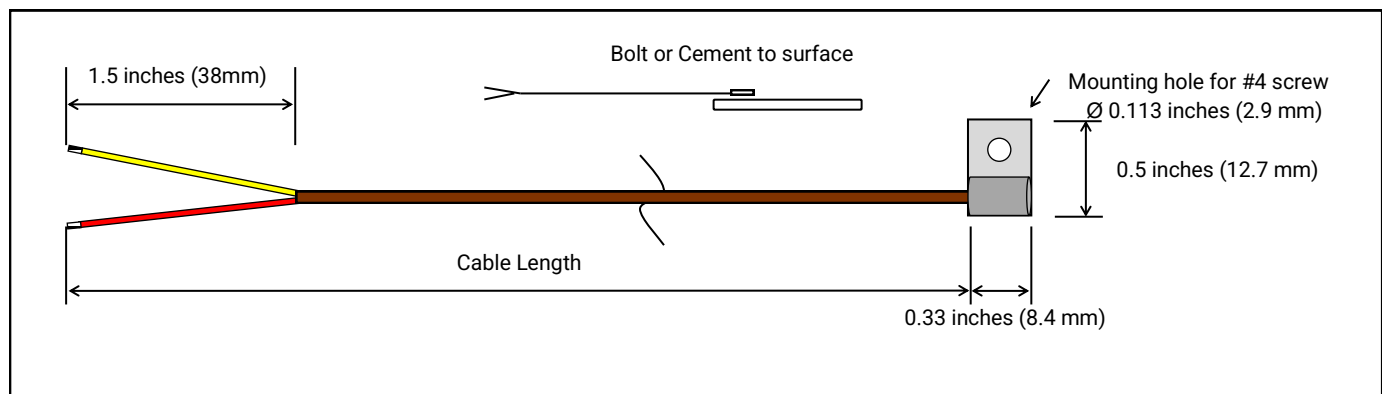

ORDERING INFORMATION

Model	Cable Length	Junction	Calibration	Connector
SMBD-TC	- □□□	- □	- □	- □□
	036 36 inches 072 72 inches 180 180 inches	G Grounded U Ungrounded	E Type E J Type J K Type K T Type T	N No connector MP Male mini-plug SP Male standard plug

ORDERING EXAMPLE

SMBD-TC-036-U-K-N: Bolt Down Thermocouple, 36 inch long cable, Ungrounded, Type K, no connector

